



Magnetic sensor

RC 40 1W-1m

Material number: 1046063 (Material number old: 24030101)

Features/Options:

- Thermoplastic enclosure
- Long life
- 1 Reed contact
- Actuation from front and from side
- Switching distance up to 29 mm depending on the actuating magnet
- With pre-wired cable

Notes

- The actuator is not included in the delivery of the switches

Dimensions

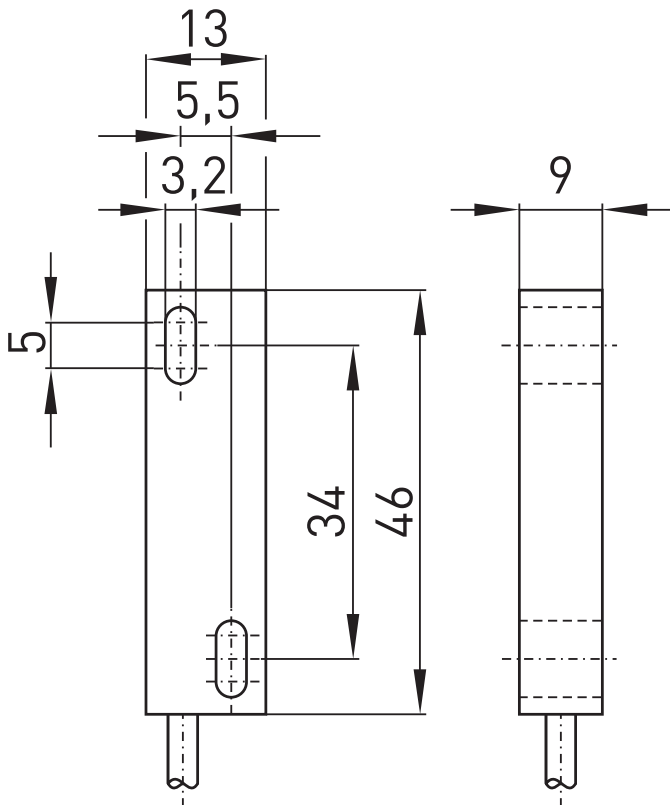

Technical data

| | |
|----------------------|-----------------------------------|
| Applied standards | EN 60947-5-2 |
| Enclosure | polyamide, glass-fibre reinforced |
| Degree of protection | IP 67 to IEC/EN 60529 |
| Switching system | reed contacts |
| Switching elements | 1 change-over contact |
| Connection | pre-wired cable PVC LiYY AWG 26 |
| Cable cross-section | 3 x 0.14 mm ² |
| Cable length | 1 m |
| Switching voltage | max. 120 VAC / 175 VDC |
| Switching current | max. 0.25 A |
| Switching capacity | max. 3 W |
| Switching frequency | max. 200 Hz |
| Ambient temperature | -10 °C ... +80 °C |
| Mechanical life | 10 ⁹ operations |
| Repeatability | ± 0.02 mm |
| Vibration resistance | 20 g |
| Weight | 20 g |

Errors and omissions excepted.



Magnetic sensor

RC 40 1W-1m

Material number: 1046063 (Material number old: 24030101)

Contact diagram

